

INFO

12/2015

www.alcaplast.com



NEW

Glass flush plates STRIPE-GL1200/GL1204

Tailored to fit offers stainless steel linear drains

NEW

GLASS FLUSH PLATES STRIPE-GL1200 AND STRIPE-GL1204

New flush plate with a flat design that fits into any modern bathroom. Perfect surface finish and a simple shape of flush plate emphasize the exclusive glass material used. Elements of stainless steel, which are among the most sought after materials, flawlessly complement this modern design. It is a dual flush system using large and small flush buttons. Furthermore, these flush plates are fully compatible with all our ALCA pre-wall installation systems.



NEW

STRIPE-GL1200

Glass flush plate for pre-wall installation system – white

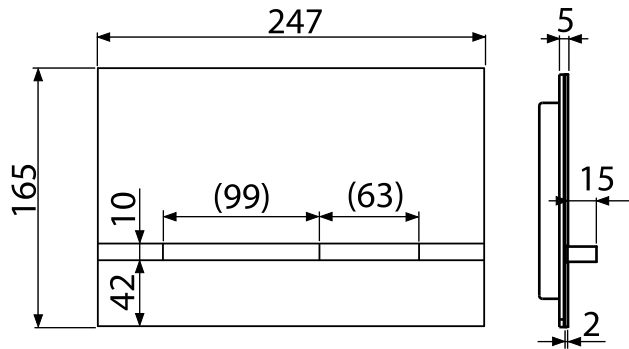

Packaging – STRIPE-GL1200	10 pcs
Dimensions (piece)	255x175x85 mm
Weight (piece)	1,5485 kg
EAN	8595580546212

STRIPE-GL1204

Glass flush plate for pre-wall installation system – black

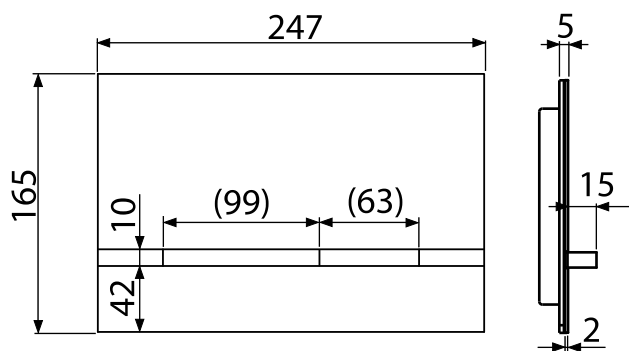

Packaging – STRIPE-GL1204	10 pcs
Dimensions (piece)	255x175x85 mm
Weight (piece)	1,5485 kg
EAN	8595580546205

INFO

TAILORED TO FIT OFFERS STAINLESS STEEL LINEAR DRAINS – FROM 1ST OF JANUARY 2016

To simplify our offers and range of our stainless steel linear drains, we decided to stop selling our drain with a grid for embedded tiles (series APZ7, APZ107, APZ1007, APZ1107).

The grid FLOOR for embedded tiles, though, will remain in our product range.

which then can be used in combination with our linear drains APZ6, APZ106, APZ1006, APZ1106.

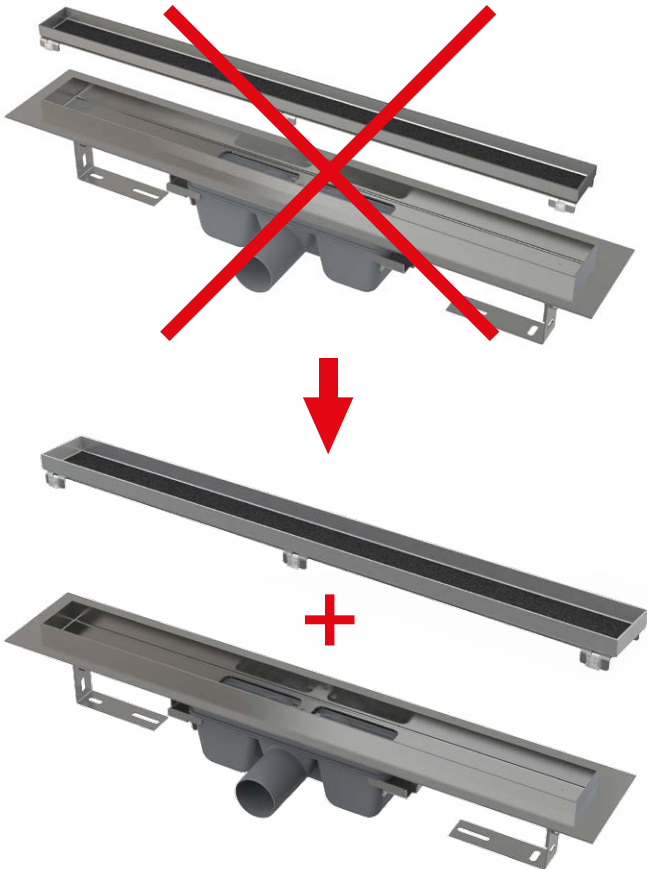

**APZ7
ONLY AVAILABLE WHILE
STOCKS LAST**

GRID FLOOR

+

APZ6

NOW ORDERED SEPARATELY

The ALCAPLAST team of Specialists is always on hand to help with design, installation and project quote prices!

Czech product
ISO 9001:2008



EN 55014-1, EN 55014-2, EN 61000-6, EN 61000-4
NV 616/2006 Coll. Coll. As amended
2011/95 / EC including amendments

Alca PLAST[®]

CZECH REPUBLIC

Alca plast, s. r. o.
Bratislavská 2846, 690 02 Breclav
tel. : +420 519 821 117 - Sales Dept. CZ
tel. +420 519 821 041 - Export Dept.
fax: +420 519 821 083
alcaplast@alcaplast.com
www.alcaplast.com